



**NDS3542D**

**Multi-input Modulator**



## Outline

NDS3542D multi-input modulator is DEXIN's all-in-one device which integrates demodulation, trans-mux and modulation in one case to convert signals into RF output. It is a 1-U case which supports 4 tuner inputs to receive signal from satellite, cable or terrestrial. To meet customers' various requirements, NDS3542D is also equipped with 2 ASI input, and output with 2 groups separate ASI ports and IP port. The output modulated signals are to be received by TVs, STB and etc.

The USB port is designed to record encoded video (TS) and save it in ts files in the USB Keys or Hard Disks, and then the ts files can be playback through the USB port.

The four CAMs/CIs (Optional) accompanied and BISS modules can descramble the programs input from 4 Tuner inputs. Its pluggable structure design greatly facilitates the change of modules (demodulator) as needed.



All the specifications are subject to change without any further notice. All rights reserved.

Address: No. 10 & No. 12, Wuxing Fourth Road, Wuhou District, Chengdu 610045, Sichuan, P.R. China  
www.dsdvb.com/English Tel: +86-028-85558928 Fax: +86-028-85585255 Email: sunyu@dsdvb.com



# USB Recorder & Player

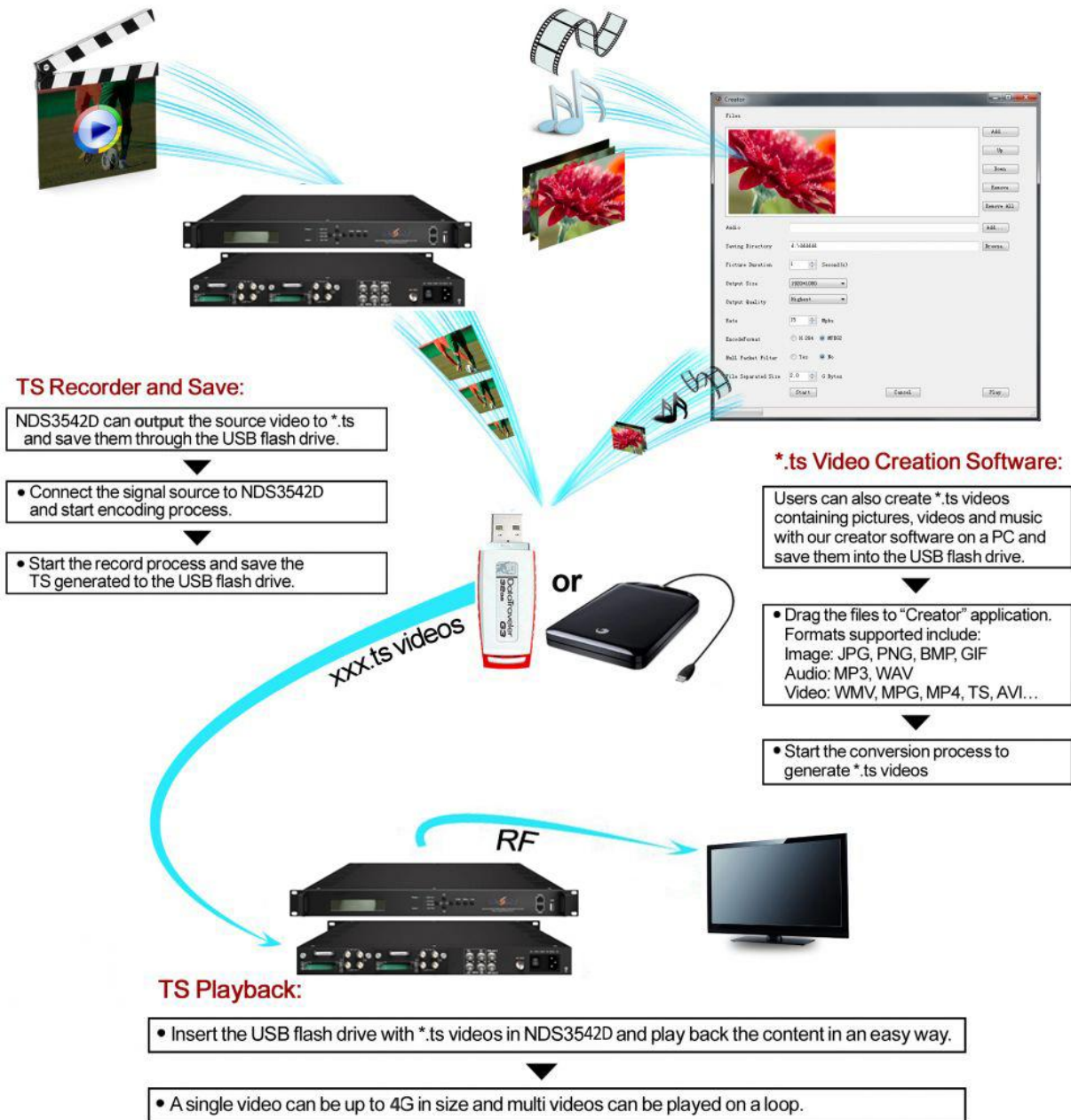

USB Flash Drive Specifications Required: High Speed 2.0; File System FAT32

## Key Features

- 4 Tuner (DVB-T/(T)/S/S2/S2X optional) + 2 ASI input
- 2 DVB-T RF out+2 MPTS out over UDP+2 ASI out as mirror of 2 RF (for DVB-T RF out)
- 4 DVB-C RF out +4 MPTS out over UDP+2 ASI out as mirror of 2 RF (for DVB-C RF out)

---version I



All the specifications are subject to change without any further notice. All rights reserved.

Address: No. 10 & No. 12, Wuxing Fourth Road, Wuhou District, Chengdu 610045, Sichuan, P.R. China  
www.dsdvb.com/English Tel: +86-028-85558928 Fax: +86-028-85585255 Email: sunyu@dsdvb.com

- 4 DVB-C RF out +8 SPTS out over UDP+2 ASI out as mirror of 2 RF (for DVB-C RF out)  
---version II
- 4 CAM decrypt multiple programs from 4 Tuner input(Optional)
- Support BISS descrambling
- Record encoded TS and playback TS files (\*.ts) through USB port
- Support accurate PCR adjusting, PSI/SI editing and inserting, PID Remapping
- Support LCD display, keyboard and Web management, Updates via web and USB

## Specifications

Input	4 Tuner (DVB-T/(T)/S/S2/S2X optional) and 2 ASI input			
Tuner Section	DVB-T/(T)	Input Frequency	30~1000MHz	
		Bandwidth	6/7/8M	
	Version 1	DVB-S	Input Frequency	950~2150MHz
			Symbol rate	1~45 Msps
			Signal Strength	-65~-25dBm
			FEC	1/2, 2/3, 3/4, 5/6, 7/8
			Constellation	QPSK
		Max input bitrate	≤120 Mbps	
		DVB-S2	Input Frequency	950~2150MHz
			Symbol rate	QPSK 1~45 Msps 8PSK 2~30 Msps
			FEC	1/2, 3/5, 2/3, 3/4, 4/5, 5/6, 8/9, 9/10
			Constellation	QPSK, 8PSK
	Max input bitrate		≤120 Mbps	
	Version 2 (New)	DVB-S	Input Frequency	950~2150MHz
			Symbol rate	0.5~45Msps
			Signal Strength	- 65- -25dBm
			FEC	1/2, 2/3, 3/4, 5/6, 7/8
			Constellation	QPSK
		Max input bitrate	≤160 Mbps	
		DVB-S2	Input Frequency	950~2150MHz
			Symbol rate	QPSK/8PSK /16APSK: 0.5~45 Msps 32APSK: 0.5~40Msps;
			FEC	QPSK: 1/2, 3/5, 2/3, 3/4, 4/5, 5/6, 8/9, 9/10 8PSK: 3/5, 2/3, 3/4, 5/6, 8/9, 9/10 16APSK: 2/3, 3/4, 4/5, 5/6, 8/9, 9/10 32APSK: 3/4, 4/5, 5/6, 8/9, 9/10
			Constellation	QPSK, 8PSK, 16APSK, 32APSK
Max input bitrate			≤160 Mbps	
DVB-S2X	Input Frequency	950~2150MHz		
	Symbol rate	QPSK/8PSK /16APSK :0.5~45 Msps		

				8APSK/32APSK: 0.5~40Msps	
			FEC	QPSK: 1/2, 3/5, 2/3, 3/4, 4/5, 5/6, 8/9, 9/10, 13/45, 9/20, 11/20 8PSK: 3/5, 2/3, 3/4, 5/6, 8/9, 9/10 8APSK: 5/9-L, 26/45-L 16APSK: 2/3, 3/4, 4/5, 5/6, 8/9, 9/10, 1/2-L, 8/15-L, 5/9-L, 26/45, 3/5, 3/5-L, 28/45, 23/36, 2/3-L, 25/36, 13/18, 7/9, 77/90 32APSK: 3/4, 4/5, 5/6, 8/9, 2/3-L, 32/45, 11/15, 7/9	
			Constellation	QPSK, 8PSK, 8APSK, 16APSK, 32APSK	
			Max input bitrate	≤160 Mbps	
<b>Multiplexing</b>	Maximum PID Remapping	128per input channel			
	Function	PID remapping (automatically or manually)			
		Accurate PCR adjusting			
		Generate PSI/SI table automatically			
<b>Modulation</b>	DVB-C	Standard	J.83A(DVB-C), J.83B, J.83C		
		MER	≥40dB		
		RF frequency	30~999MHz, 1KHz step		
		RF output level	-20~0dbm(87~107 dbμV),0.1db step		
		Symbol rate	5.0Msps-9.0Msps, 1ksps stepping		
		RF Out	4*DVB-C carriers output		
			J.83A	J.83B	J.83C
		Constellation	16/32/64/128/ 256QAM	64/256 QAM	64/256 QAM
		Bandwidth	8M	6M	6M
	DVB-T	Bandwidth	6M, 7M, 8M		
		Constellation	QPSK, 16QAM, 64QAM		
		Code rate	1/2, 2/3, 3/4, 5/6, 7/8		
		Guard Interval	1/32, 1/16, 1/8, 1/4		
		Transmission Mode	2K, 8K		
		MER	≥40dB		
		RF frequency	30~999MHz, 1KHz step		
RF Out		2*DVB-T carriers output			
RF output level	-20~0dbm(87~107 dbμV),0.1db step				
<b>TS Output</b>	2 ASI out as mirror of 2 RF carriers (BNC type)				
	2 MPTS over UDP out (RJ45, 100/1000M self-adaption) (for DVB-T RF out)				
	4 MPTS over UDP out (RJ45, 100/1000M self-adaption) (for DVB-C RF out) ---version I				
	8 SPTS over UDP out (RJ45, 100/1000M self-adaption) (for DVB-C RF out) --- version II				
<b>System</b>	Local interface	LCD + control buttons			
	Remote management	Web NMS			
	Language	English and Chinese			
	Upgrading	Web and USB			
<b>General</b>	Dimension	482mm×300mm×44.5mm(W*D*H)			

Weight	3.7kg
Temperature	0~45°C (Operation) ; -20~80°C (Storage)
Power	AC 100V±10%/60Hz; AC 220V±10%, 50/60HZ
Consumption	25W

## Working Principle

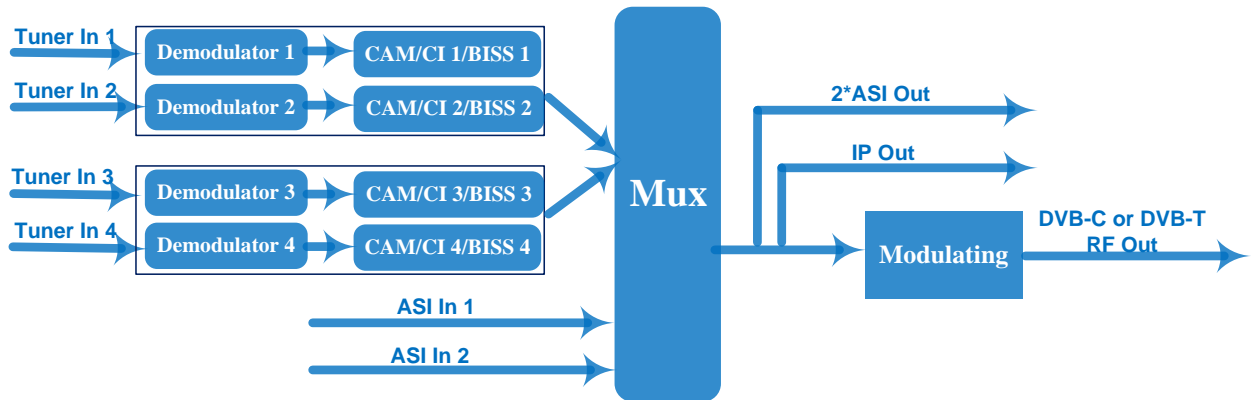

Updated Date: 8 May, 2019